

Shire of Broome

## **Broome Motel**

**Name:** Broome Motel

**Location:** Frederick Street, Broome

**Telephone:** (08) 9192 7775

**Free call:** 1800 683 867

**Accessible parking bay onsite:** 3 designated disability-parking bays

**Accessible rooms:** There are three accessible rooms.

**Closest public transport:** Broome Town Bus stops right in front of the Motel.

**Pick up / set down bay:** One bay is provided at the front reception.

**External access:** There is a ramp access with 6 degrees (1.9) leading to level veranda 1950mm wide.

**Main entrance:** Level Access through wide 1000mm glass sliding door moderately heavy to open with 'D' handle. Good wheel chair access (Y+) with ample clearance on latch side.

**Foyer:** Wide open roomy foyer with tile floor ample wheel chair circulation (Y++). Lounge seating is provided in the foyer. The seats are soft with backs and armrests. The seating height is 500mm. There is a display showing books available for loan at sitting height.

**Reception:** The counter is high standing with 1140mm.

**Signage:** The signage is clear and easy to read.

**Accessible Public toilet:** No.

**Access to rooms:** There are 3 accessible non smoking rooms at ground level. The concrete path leading to the rooms is barrier free and 1500mm wide. There is a short ramp (1meter) with 6 degree (1.9) entry to a front veranda 2000mm wide wheel chair circulation is good (Y++).

### **Accessible rooms:**

**Room Door:** Entrance to the room is level. The glass sliding door is 960mm wide with a key entry. The door has a 'D'; handle and is light to open and closes manually. There is ample clearance on the latch side for wheelchair access.

**Bed:** There is sufficient circulation space with 1200m either side of the non movable queen size bed. The bed is soft and 530mm high with 110mm clearance. The floor is tiled and level throughout.

**Kitchen area:** the kitchen bench is at sitting height 780mm and has tea & coffee making facilities. Wheelchair access is good.

**Lounge:** The seats are soft with backrests and have a seating height of 500mm. Wheelchair access is good.

**Room facilities:** include TV with remote control, telephone and low light switches, air-conditioning and ceiling fan, an AM/FM clock radio and a refrigerator.

**Breakfast:** Room service will deliver breakfast.

Toilet and shower: The toilet door is 820mm wide and light to open. It has a knob with push button lock and there is a small snib. There is good clearance on the latch side 440mm and wheelchair circulation is good (Y++). The area is 2100mm x 2800mm.

Pan: height is 450mm

Washbasin: height is 790mm with knee clearance.

Shower: The shower area is spacious with 1100m x 1200mm. There is a fold down seat of 450mm height and the access to shower is level and 1200mm wide.

- T = Toilet
- WB = Wash Basin
- SD = Swing door
- SLD = Sliding door
- SWR = Shower recess

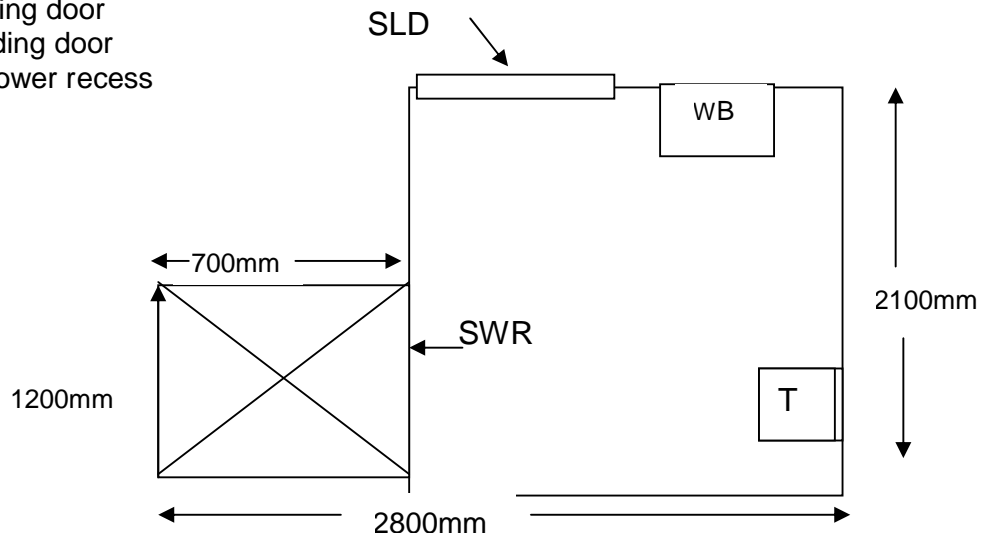



**Guest laundry:** Is to the rear of the Motel and has an accessible parking bay. The door is open from 7am – 7pm and is 920mm wide with an internal clearance of 1300mm on the latch side. The laundry has good internal circulation space, two top loading machines and 2 dryers. The machines are 900mm high and are coin-operated. There is also an ironing facility.

**Pool:**

The swimming pool is situated to the left of the entry driveway of the Broome Motel. It is an open air 12m pool with sailcloth shading overhead.

The access is barrier free and the door is 1050mm wide and has a lift-up knob in 1600mm high for entry. Wheelchair access and circulation is good. The door is light to open and quick to close. The pool is a 'Roman Bath' style with a small 50mm lip and a 3 step entry. There is a change table with good knee clearance and bench seating. There is also a round garden table with plastic chairs with armrests and backs. There are four lounge recliners available and ample wheelchair clearance all round the pool area. But no accessible toilet and change room are provided.

**Information collected by:**

**Shire of Broome August 2007**

**Care has been taken to ensure the accuracy of this information however no guarantee is given that the facility is fully accessible.**

**Please advise the Shire of Broome of any access changes since publication.**

'You're Welcome WA Access Initiative' © Disability Services Commission 2007



The **You're Welcome WA Access Initiative** was developed by the Disability Services Commission in partnership with the Western Australian Local Government Association, Ministerial Advisory Council on Disability, People with Disabilities (WA) Inc, Tourism Western Australia, ACROD WA, NICAN WA and the City of Perth.