

Shire of Broome

## **Broome Public Library**

**Location:** Cnr Hamersley & Haas Street

**Facilities/Services:** Books, Magazines, Newspaper, DVD's, Videos and Computer discs for loan, Computer Access, Story Time and other Kids Activities, Author Nights

**Opening Hours:** Monday, Wednesday & Friday 10.00am – 5.00pm  
Tuesday & Thursday 10.00am – 7.00pm  
Saturday 9.00am – 12.00pm

**Telephone:** (08) 9191 3477

**Web:** [www.broome.wa.gov.au/library.htm](http://www.broome.wa.gov.au/library.htm)

**Closest accessible parking:** There is one designated parking bay near the entrance of the library.

**Pick up / set down bay:** No.

**Closest public transport:** The nearest Town Bus stop can be found on Carnarvon Street, near Matso's Broome Brewery, about 7-10 minutes away.

**Closest accessible toilet:** Onsite.

**Signage:** Clear and easy to read signage from roadways. There are also plenty directional signs within the library.

**External access:** There are two brick paved and ramped pathways leading to the entry. Both are barrier free and 1600mm with handrails. Wheelchair access (Y++).

**Main entrance:** Level Entrance with wide 1060mm automatic glass door

**Internal:** Low piled carpet and barrier free wide aisles make for easy wheelchair circulation.

**Displays/Shelves:** The shelves have 4 different height levels and can be reached either at sitting or standing height.

**Service counters:** The service counter is at standing and sitting height.

**Cueing system:** Counter service operates by the customer service staff calling 'next please'. There are no visual prompts.

**Accessible toilet:** There is a unisex accessible toilet with barrier free access and good wheelchair circulation.

**Toilet door:** The door is 850mm wide and light to open and close. There is good clearance on both, the inside and outside of the latch.

**Pan height:** 490mm

**Wash basin:** 860mm

**Change Table:** There is a fold down change table 960mm high with good knee clearance.

**Lighting:** The light is on at all times.

- T = Toilet
- WB = Wash Basin
- SD = Swing door
- SLD = Sliding door
- SWR = Shower recess
- CT = Change Table

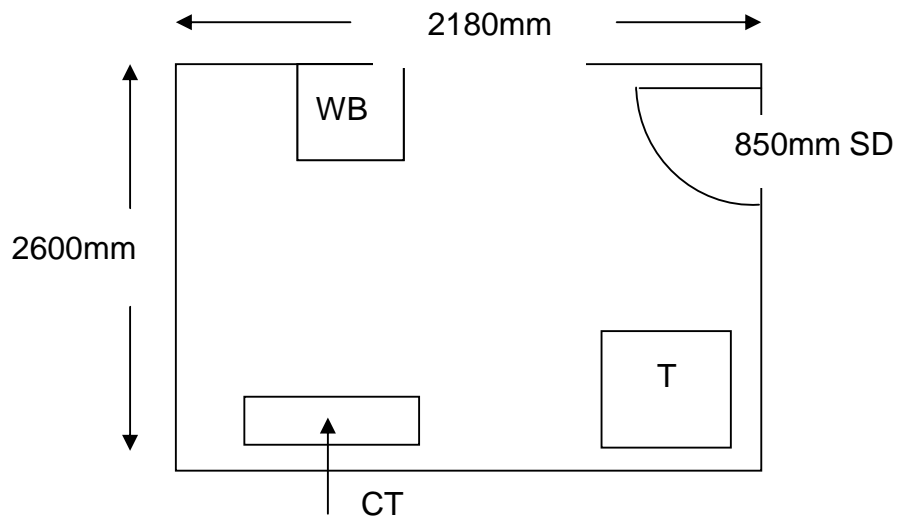

Information collected by:  
**Shire of Broome August 2007**

**Care has been taken to ensure the accuracy of this information however no guarantee is given that the facility is fully accessible.  
 Please advise the Shire of Broome of any access changes since publication.**

'You're Welcome WA Access Initiative' © Disability Services Commission 2007



The **You're Welcome WA Access Initiative** was developed by the Disability Services Commission in partnership with the Western Australian Local Government Association, Ministerial Advisory Council on Disability, People with Disabilities (WA) Inc, Tourism Western Australia, ACROD WA, NICAN WA and the City of Perth.