

Shire of Broome

Seashells Resort Broome

Location: 4 - 6 Challenor Drive, Cable Beach

Telephone: (08) 9192 1011

Web: www.seashells.com.au

Accessible parking bay onsite: Yes, one located outside the accessible unit

Drop off available: Yes, at the entrance to the foyer

Closest public transport: Town Bus Stop on Challenor Drive, very close to the resort

Accessible public toilet onsite: Yes

Accessible parking: Yes

Pick up / set down bay: Right in front of the entrance

Signage: Large sign easily seen from main road.

External access: Pedestrian ramp with a gradient of 4.1 (1.14) leads to the main entrance.

Main entrance: A sliding door of 750mm with a 'D' handle and automatic closer. The door is light to open and slow to close. There is a 150mm step at the entrance.

Foyer: Tiled floors throughout and ample circulation space for all wheelchair types (Y++).

Lounge seating is provided in the foyer. The seats are firm with armrests and backrests with a seating height of 500mm. There is a second door, which is 820mm wide. It leads to the swimming pool and to the accommodation units. Portage is available.

Reception: Counter is at standing height.

Accessible public toilet:

External access: An accessible toilet is located in the foyer.

Signage: General toilet sign.

Door: 820mm wide with a swing door with a 'D' handle and a small snib. The door is heavy to open and fast to close. There is a 400mm clearance on the latch side internally.

Pan height: 450mm.

Basin height: 860mm.

Lighting: Light switch at a height of 1400mm.

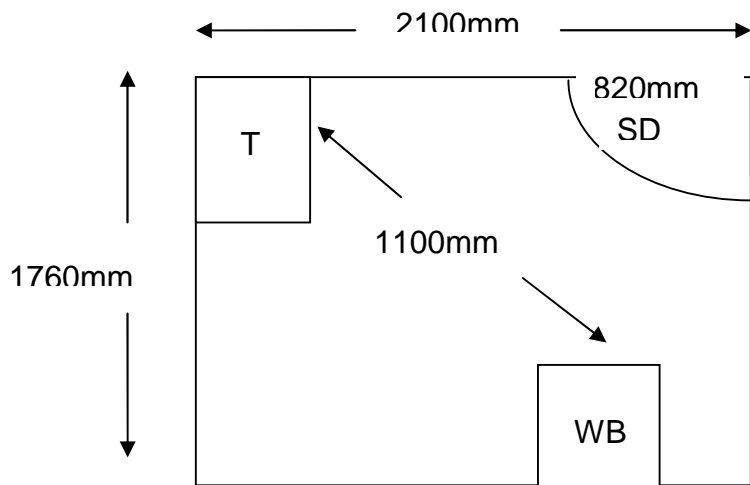

- T = Toilet
- WB = Wash Basin
- SD = Swing door
- SLD = Sliding door
- SWR = Shower recess



Accessible rooms: There is one accessible non-smoking room with self-catering facilities. It has two bedrooms. The main bedroom has a queen-sized bed. The second has two single beds. The unit is spacious with good wheelchair access to kitchen, dining and lounge area.

Emergency: Emergency map on the back of entry door.

Access to the room: A barrier free brick paved pathway of 1500mm with a short gradient leads to the room door.

Accessible rooms:

Door: The room door is 800mm wide. It is a swing door with a key entry and a knob handle. There is ample clearance on the latch side for wheelchairs. The light switches are 1350mm high.

Kitchen & Dining: Tea & coffee facilities are reachable for wheelchair users. Bench tops are at sitting height and the kitchen area has ample circulation space for wheelchair users. The dining table is large with good knee clearance. The chairs have a padded seat with a seat height of 480mm.

Lounge: Lounge seating is soft with backrest, armrest and footrest. The seat height is 500mm. The lounge area is spacious with ample circulation space for wheelchairs.

Bedroom 1: The main bedroom door is 800mm wide with a knob handle. The queen-size bed is on castors. The bed is soft to sit on and has a height of 560mm with a 130mm under bed clearance to accommodate a mobile hoist. There is 1000mm clearance space on one side of the bed and 750mm clearance on the other. There is 850mm clearance space at the base of the bed.

Bedroom 2: The second bedroom has two single beds with a 1140mm space between each bed.

Laundry: Washer and dryer are accommodated behind 2 bi fold doors with a working heights of 900mm. The handles are 900mm high as well.

Bathroom:

The ensuite bathroom has two access doors. The door from the bedroom is a sliding door with a 800mm entrance. The door from the hallway is a swing door 780mm wide. There is a separate toilet cubicle for guests.

Pan height: 500mm high.

Basin height: 900mm with knee clearance.

Shower: Level access with fold down seat.

Emergency call buttons: No.

- T = Toilet
- WB = Wash Basin
- SD = Swing door
- SLD = Sliding door
- SWR = Shower recess

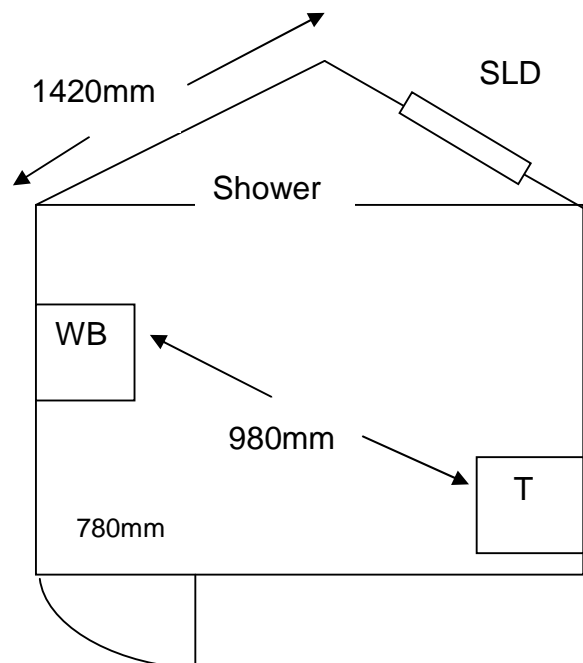



Pool:

Location: The outdoor swimming pool is open from 7am – 9pm. The gates are light to open and slow to close.

Door/Gate: There are two access gates each of them 880mm wide with a lift up knob latch mechanism at the height of 1500mm.

Style: The pool is a 'roman bath' style with shade cloth shading overhead to most areas. Access into the pool is by steps with a handrail. There is a separate children pool. Wheelchair patrons should be able to access most areas surrounding the pool. The nearest accessible toilet is located in the foyer.

Information collected by:

Shire of Broome August 2007

Care has been taken to ensure the accuracy of this information however no guarantee is given that the facility is fully accessible.

Please advise the Shire of Broome of any access changes since publication.

'You're Welcome WA Access Initiative' © Disability Services Commission 2007



The **You're Welcome WA Access Initiative** was developed by the Disability Services Commission in partnership with the Western Australian Local Government Association, Ministerial Advisory Council on Disability, People with Disabilities (WA) Inc, Tourism Western Australia, ACROD WA, NICAN WA and the City of Perth.