

CORPUS :- 12 / 2700 x 3500
 DISK PARK :- 2 / 3200 x 3500

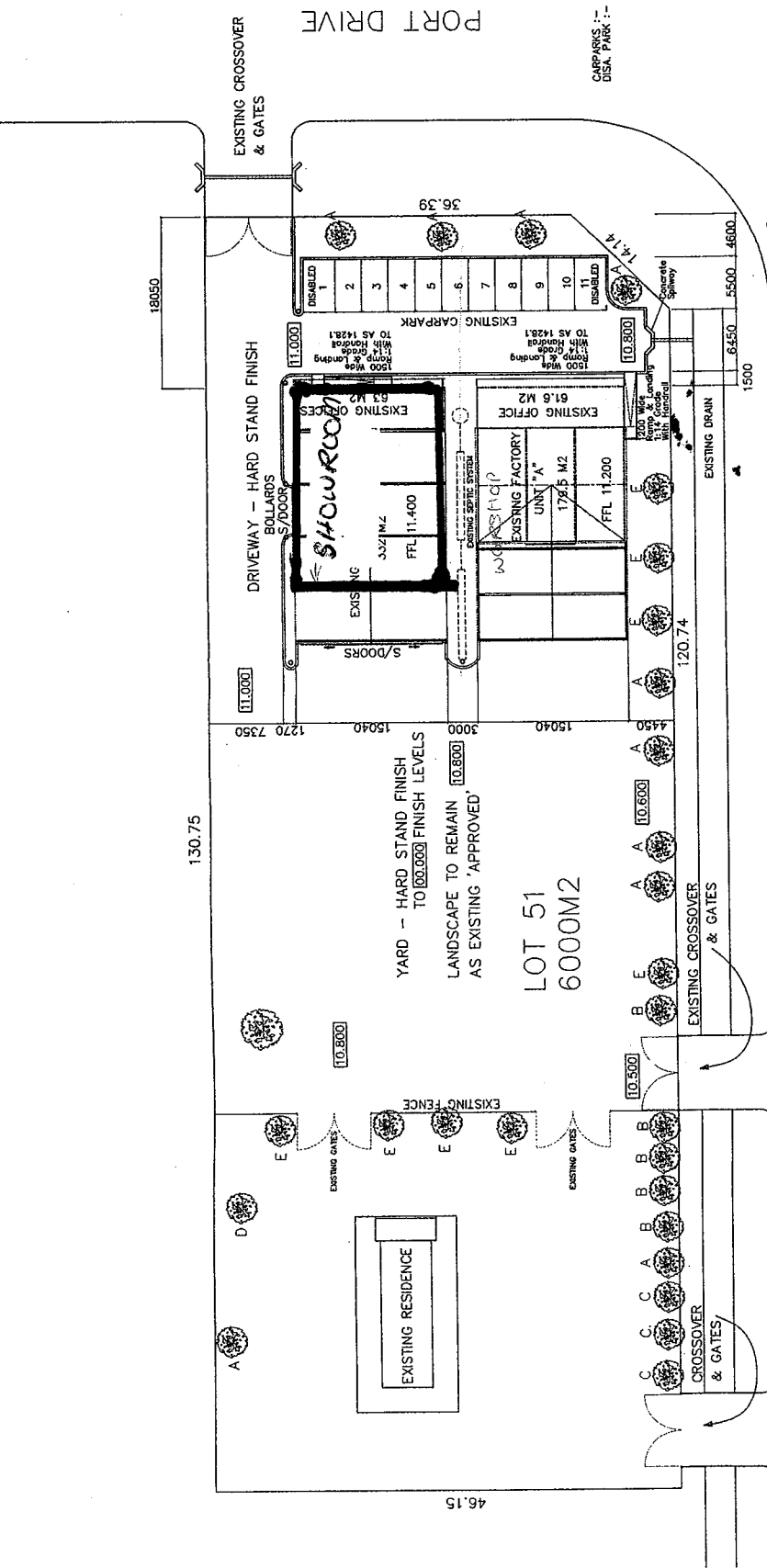
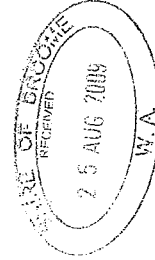

- EXISTING TREES
 A - SWEET WOOD TREE
 B - SORREL TREE
 C - MALALUKA TREE
 D - WEEPING ROSEWOOD
 E - MANGO TREE

DRAWING

SITE PLAN

"This document is a draft and remains the property of National Steel Frames WA. It is intended for client review only and should not be used for construction without the express written commission and in accordance with the terms of engagement for the commission. Unauthorised use of this document in any way is prohibited." ©

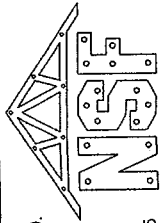

NATIONAL STEEL FRAMES WA.
 A.B.N. 66 102 306 721

28 PEMBROKE RD.
 P.O. BOX 821
 BROOME WA. 6725
 Ph. 91935153
 Fax. 91935153
 Mob. 0418900025

DRAWN	DATE	CHECKED	DATE	DRAWING No	SCALE
S.G.T.	24.08.09	S.G.T.	24.08.09	340	1/1
SAVED AS :- G:\Work Files\Job-Folder\XXXXX\Job-XXX\XXX					

CLIENT :- L MATHES

PROJECT :- NEW FACTORY UNIT & EXTENSIONS

ADDRESS :- LOT 51 PORT DRIVE, Cnr DE CASTILLA, BROOME