

SHIRE OF BROOME  
RECEIVED  
-2 APR 2008  
M.A.

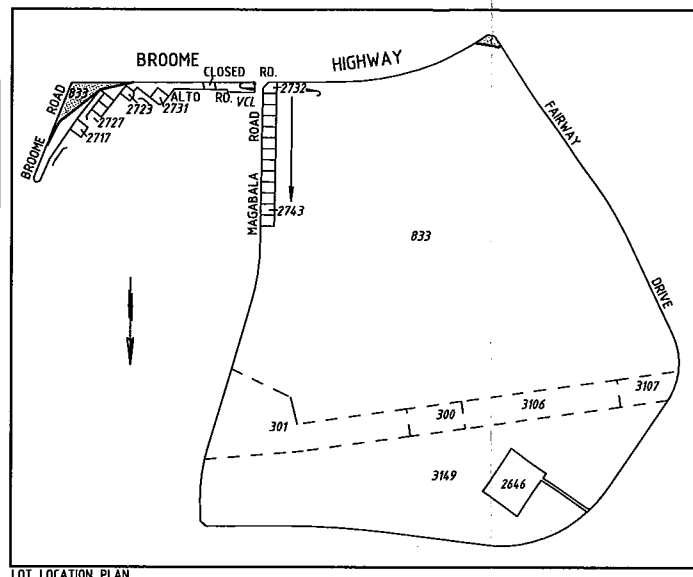
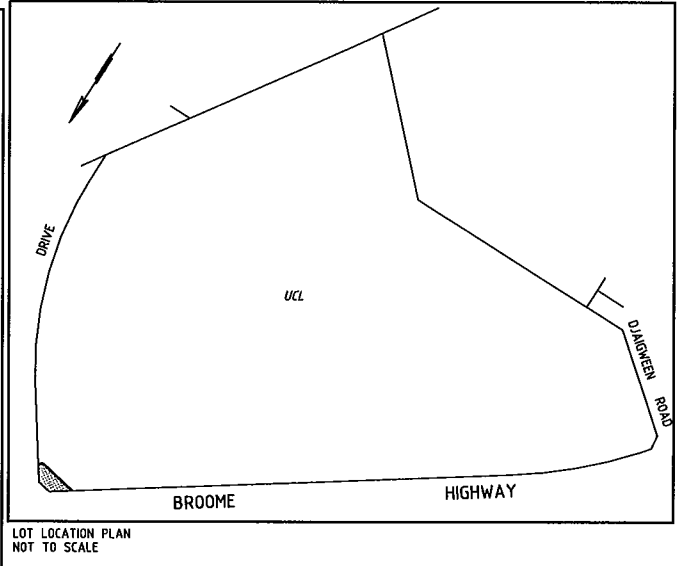
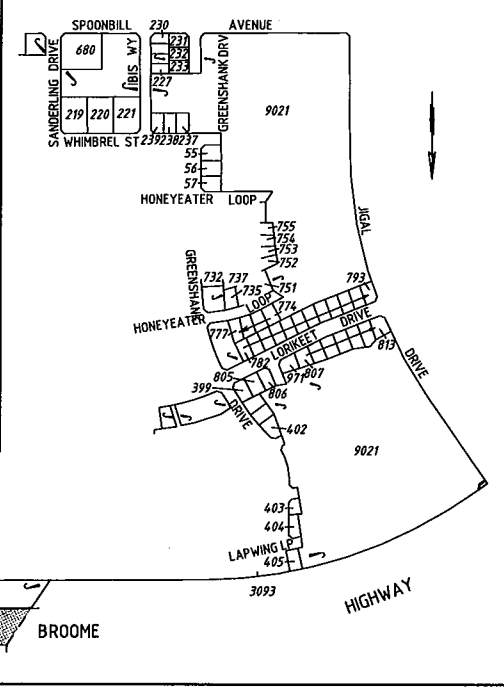
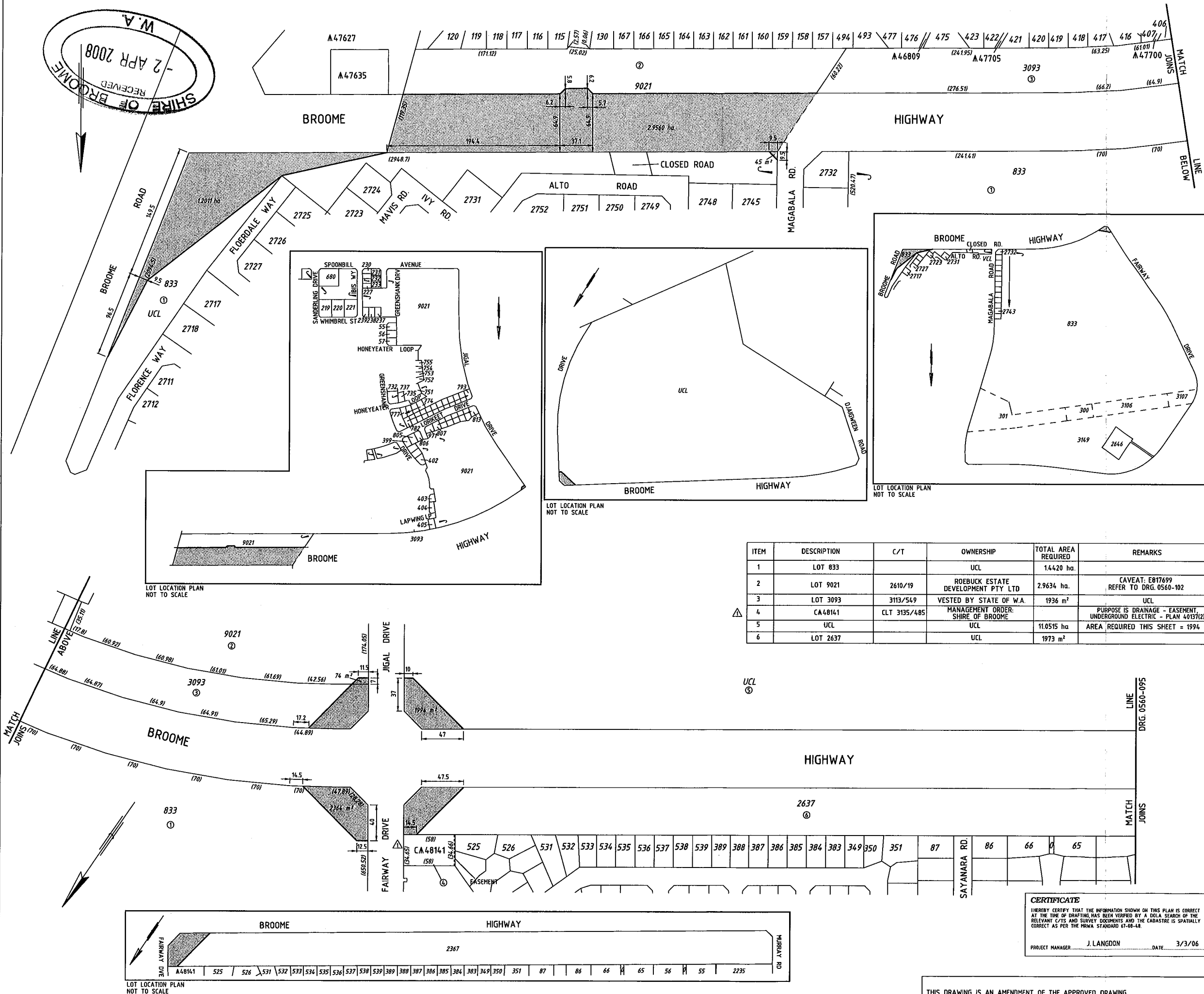

| ITEM | DESCRIPTION | C/T          | OWNERSHIP                          | TOTAL AREA REQUIRED | REMARKS  |
|------|-------------|--------------|------------------------------------|---------------------|--|
| 1    | LOT 833     |              | UCL                                | 1,4420 ha.          |  |
| 2    | LOT 9021    | 2610/19      | ROEBUCK ESTATE DEVELOPMENT PTY LTD | 2,9634 ha.          | CAVEAT: E817699 REFER TO DRG. 0560-102                               |
| 3    | LOT 3093    | 3113/549     | VESTED BY STATE OF W.A.            | 1936 m <sup>2</sup> | UCL  |
| 4    | CA 48141    | CLT 3135/485 | MANAGEMENT ORDER: SHIRE OF BROOME  |                     | PURPOSE IS DRAINAGE - EASEMENT, UNDERGROUND ELECTRIC - PLAN 40137(2) |
| 5    | UCL         |              | UCL                                | 11,0515 ha          | AREA REQUIRED THIS SHEET = 1994 m <sup>2</sup>                       |
| 6    | LOT 2637    |              | UCL                                | 1973 m <sup>2</sup> |  |

| NO. | DESCRIPTION                                       | AUTHORISED | DATE | MISC DATE |
|-----|---|------------|------|-----------|
| 1.  | REQUIREMENT FROM ITEM 4. REMOVED, ITEM 5. AMENDED |            |      |           |

**LEGEND**

■ LAND REQUIRED FOR ROAD PURPOSES.

— BOUNDARY TO BE SURVEYED.

**NOTES**

- DIMENSIONS AND AREAS ARE APPROXIMATE ONLY AND ARE SUBJECT TO SURVEY.
- S.L.K. IS A M.R.W.A. STRAIGHT LINE KILOMETRE AND IS APPROXIMATE ONLY.
- CADASTRAL MODEL : CAD0871A
- HORIZONTAL DATUM IS MGA 94.

**KIMBERLEY REGION**

Telephone (08) 9158 4333 Fax (08) 9158 4334

**APPROVED FOR IMPLEMENTATION**

|             |            |      |        |                 |  |
|-------------|------------|------|--------|-----------------|--|
| FILE NUMBER | 05/9941    | DATE | 6/4/06 | APPROVAL NUMBER |  |
| AUTHORISED  | M. SALT    |      |        |                 |  |
| APPROVED    | P. PODLAHA |      | 6/4/06 |                 |  |

Government of Western Australia

**MAIN ROADS**  
Western Australia

FINANCE AND SERVICES  
**PROPERTY MANAGEMENT**  
Telephone 9323 4580 Fax 9323 4600

**Jimsan CAD Services**

TEL: 9 345 1802 EMAIL: langdon@dodo.com.au

**BROOME HIGHWAY, H42**

LAND DEALINGS  
SHEET 1 OF 6

LOCAL AUTHORITY (001) SHIRE OF BROOME

DRAWING TYPE 7200 DRAWING NUMBER

FILE NUMBER 05/9941

**0560-094-1**

**CERTIFICATE**

I HEREBY CERTIFY THAT THE INFORMATION SHOWN ON THIS PLAN IS CORRECT AT THE TIME OF DRAFTING HAS BEEN VERIFIED BY A DOLA SEARCH OF THE RELEVANT C/T'S AND SURVEY DOCUMENTS AND THE CADASTRE IS SPATIALLY CORRECT AS PER THE MRWA STANDARD 67-08-48.

PROJECT MANAGER J. LANGDON DATE 3/3/06

THIS DRAWING IS AN AMENDMENT OF THE APPROVED DRAWING.

SCALE 1:2000 0 20 40 60 80 100 120 140 160 180 200 220 240 260 280 300 320 340 360 380 400

MICROFILM DATE 12 APRIL 2006

SCALE

A 1

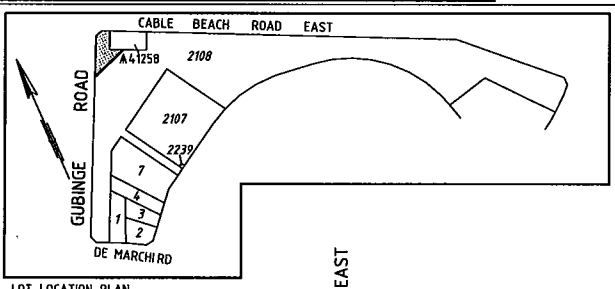
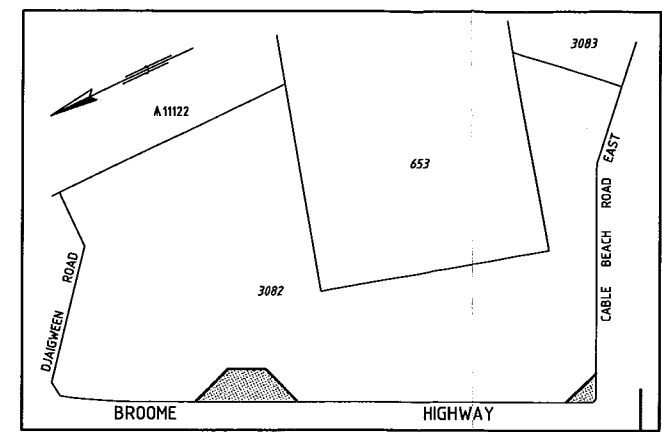
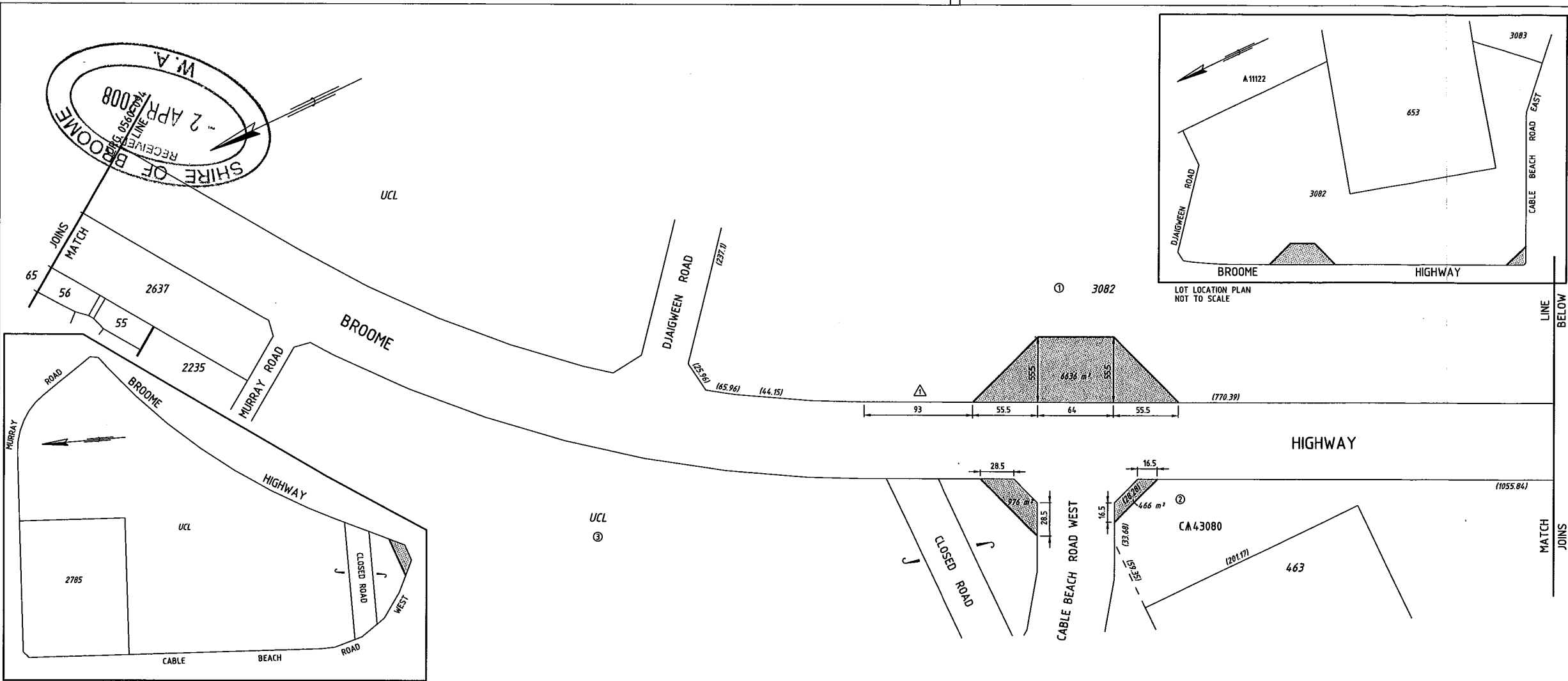

| ITEM | DESCRIPTION | CLT      | OWNERSHIP  | TOTAL AREA REQUIRED | REMARKS   |
|------|-------------|----------|--|---------------------|---|
| 1    | LOT 3082    | 3110/62  | MANAGEMENT ORDER: STATE OF WESTERN AUSTRALIA           | 7882 m <sup>2</sup> |   |
| 2    | CA43080     | 3102/643 | MANAGEMENT ORDER: DEPT. OF PLANNING AND INFRASTRUCTURE | 466 m <sup>2</sup>  | PURPOSES: COSTAL PARK RECREATION & CONSERVATION AND PROTECTION OF ABORIGINAL HERITAGE |
| 3    | UCL         |          | UCL  | 11.0515 ha          | AREA THIS SHEET = 4366 m <sup>2</sup>   |
| 4    | CA41258     | 3003/965 | MANAGEMENT ORDER: WATER AUTHORITY OF WA                |                     | PURPOSE: PUMPLINE STATION   |
| 5    | LOT 2108    |          | UCL  | 743 m <sup>2</sup>  |   |

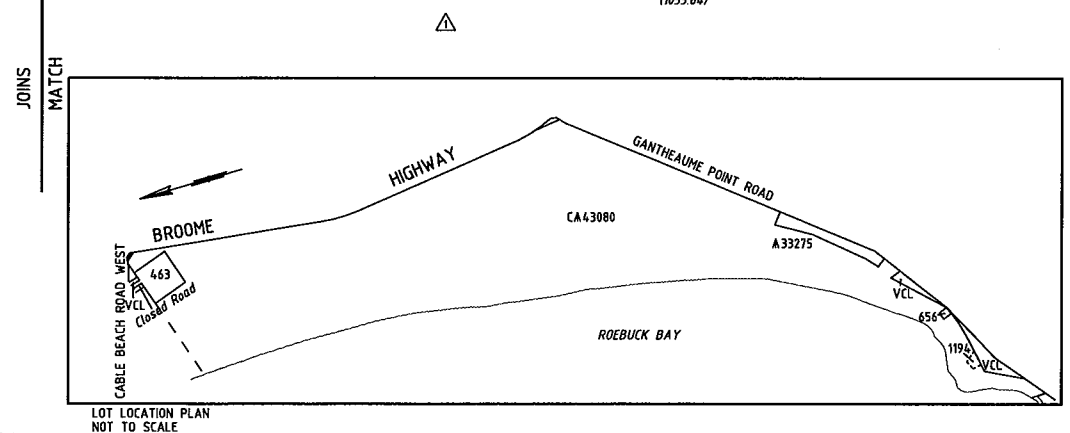
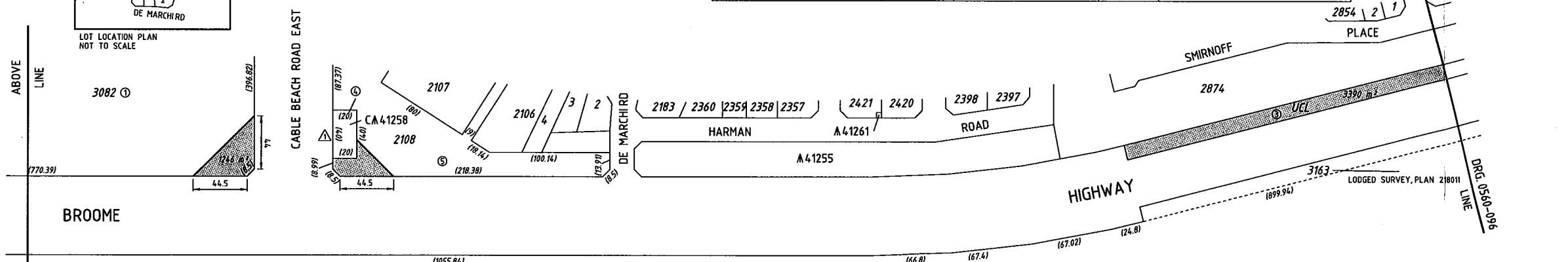

| AMENDMENTS                                 | DATE | MICRO DATE |
|--|------|------------|
| 1. ITEMS 1 & 2 AMENDED, DIMENSION INCLUDED |      |            |

### LEGEND

LAND REQUIRED FOR ROAD PURPOSES.  
 BOUNDARY TO BE SURVEYED.

### NOTES

- DIMENSIONS AND AREAS ARE APPROXIMATE ONLY AND ARE SUBJECT TO SURVEY.
- S.L.K. IS A M.R.W.A. STRAIGHT LINE KILOMETRE AND IS APPROXIMATE ONLY.
- CADASTRAL MODEL: CA00871A
- HORIZONTAL DATUM IS MGA 94.

**KIMBERLEY REGION**  
 Telephone (08) 9158 4333 Fax (08) 9158 4334

**APPROVED FOR IMPLEMENTATION**

|             |            |      |                 |
|-------------|------------|------|-----------------|
| FILE NUMBER | 05/9941    | DATE | APPROVAL NUMBER |
| AUTHORISED  | M. SALT    |      | 6/4/06          |
| APPROVED    | P. PODLAHA |      | 6/4/06          |

**MAIN ROADS Western Australia**  
 FINANCE AND SERVICES  
**PROPERTY MANAGEMENT**  
 Telephone 9323 4580 Fax 9323 4600

**Jimsan CAD Services**  
 TEL: 9 345 1802 EMAIL: langdon@dodo.com.au

**BROOME HIGHWAY, H42  
 LAND DEALINGS  
 SHEET 2 OF 6**

LOCAL AUTHORITY (001) SHIRE OF BROOME  
 DRAWING TYPE 7200 DRAWING NUMBER 05/9941  
**0560-095-1**

**CERTIFICATE**  
 I HEREBY CERTIFY THAT THE INFORMATION SHOWN ON THIS PLAN IS CORRECT AT THE TIME OF DRAFTING, HAS BEEN VERIFIED BY A DOLA SEARCH OF THE RELEVANT L/T/S AND SURVEY DOCUMENTS AND THE CADASTRE IS SPATIALLY CORRECT AS PER THE MRWA STANDARD 67-08-48.  
 PROJECT MANAGER: J. LANGDON DATE: 3/3/06

THIS DRAWING IS AN AMENDMENT OF THE APPROVED DRAWING.....

SCALE 1:2000 0 40 80 120 160 200 240 280 300 320 340 360 380 400  
 MICROFILM DATE 12 APRIL 2006  
 SCALE 1

SHIRE OF BROOME  
RECEIVED  
- 2 APR 2008  
M.A.

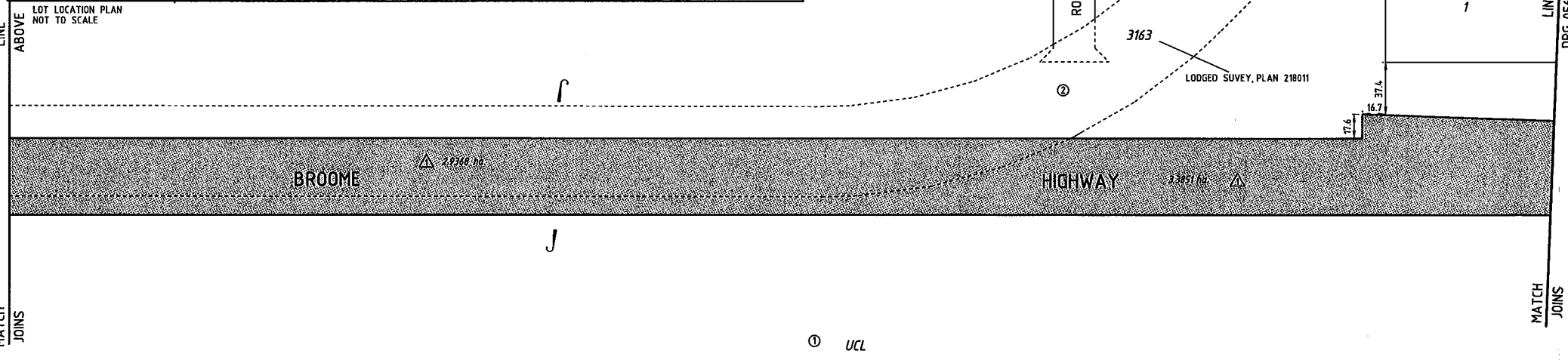
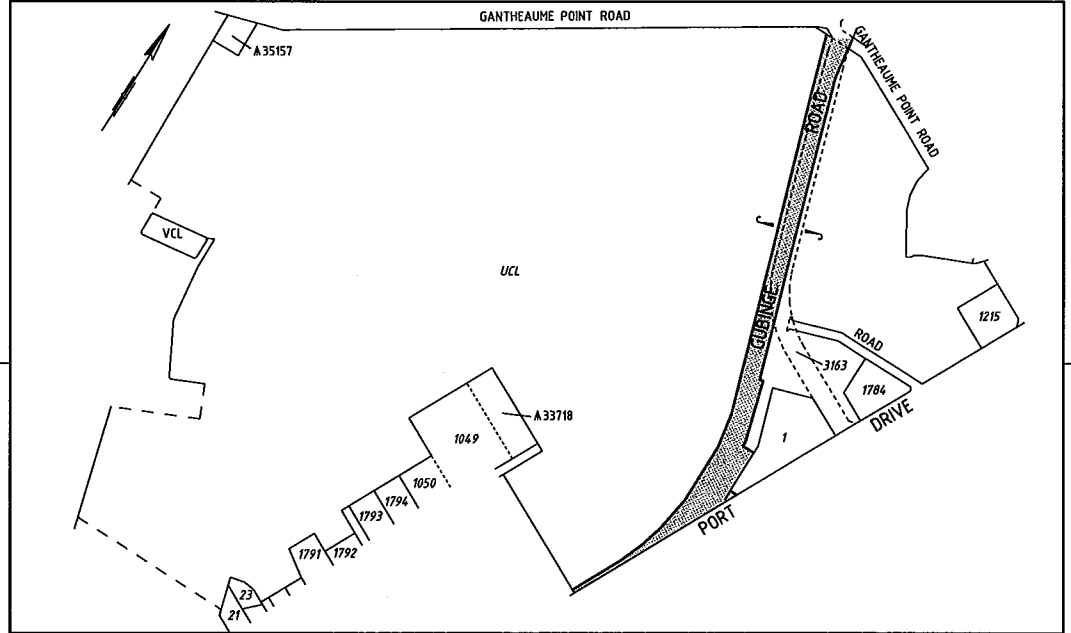
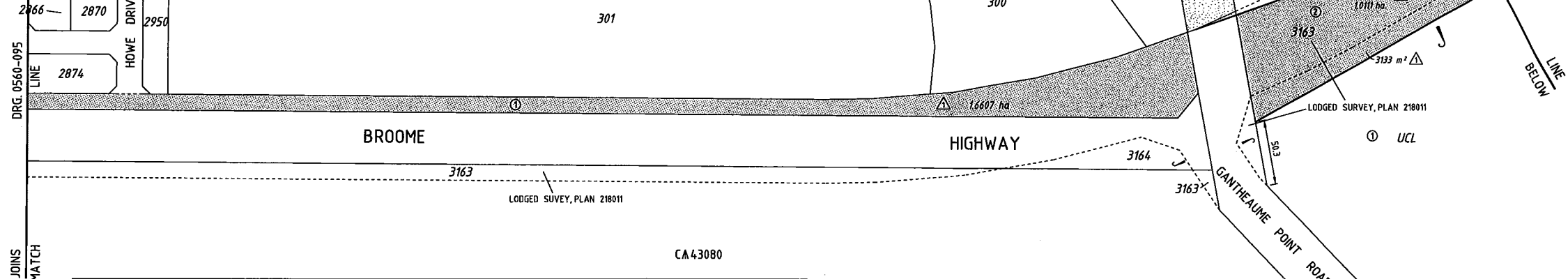

| ITEM | DESCRIPTION | C/T | OWNERSHIP | TOTAL AREA REQUIRED | REMARKS                               |
|------|-------------|-----|-----------|---------------------|---------------------------------------|
| 1    | UCL         |     | UCL       | 11,051.5 ha         | AREA REQUIRED THIS SHEET = 5,359.1 ha |
| 2    | LOT 3163    |     | UCL       | 3,947.9 ha          | LODGED SURVEY - PLAN 218011           |

**CERTIFICATE**  
I HEREBY CERTIFY THAT THE INFORMATION SHOWN ON THIS PLAN IS CORRECT AT THE TIME OF DRAFTING HAS BEEN VERIFIED BY A GDA SEARCH OF THE RELEVANT C/T'S AND SURVEY DOCUMENTS AND THE CADASTRE IS SPATIALLY CORRECT AS PER THE MRWA STANDARD 67-08-48.  
PROJECT MANAGER J. LANGDON DATE 3/3/063

| AMENDMENTS | DESCRIPTION           | DATE | AUTHORISED | MEMO DATE |
|------------|-----------------------|------|------------|-----------|
| 1          | ITEMS 1 AND 2 AMENDED |      |            |           |

**LEGEND**  
 LAND REQUIRED FOR ROAD PURPOSES.  
 BOUNDARY TO BE SURVEYED.

**NOTES**  
 1. DIMENSIONS AND AREAS ARE APPROXIMATE ONLY AND ARE SUBJECT TO SURVEY.  
 2. S.L.K. IS A M.R.W.A. STRAIGHT LINE KILOMETRE AND IS APPROXIMATE ONLY.  
 3. CADASTRAL MODEL : CAD0871A  
 4. HORIZONTAL DATUM IS MGA 94.

**KIMBERLEY REGION**  
 Telephone (08) 9158 4333 Fax (08) 9158 4334  
**APPROVED FOR IMPLEMENTATION**  
 FILE NUMBER 05/9941 DATE 6/4/06 APPROVAL NUMBER  
 AUTHORISED M. SALT 6/4/06  
 APPROVED P. PODLAHA 6/4/06

Government of Western Australia  
**MAIN ROADS** Western Australia  
 FINANCE AND SERVICES  
**PROPERTY MANAGEMENT**  
 Telephone 9323 4580 Fax 9323 4600

**Jimsan CAD Services**  
 TEL: 9 345 1802 EMAIL: langdon@jimsan.com.au

GRAPHIC PRESENTATION (ONLY) AUDITED IN ACCORDANCE WITH STANDARD 67-08-48 IN THE ROAD AND TRAFFIC ENGINEERING MANUAL.

**BROOME HIGHWAY, H42**  
 LAND DEALINGS  
 SHEET 3 OF 6

LOCAL AUTHORITY (001) SHIRE OF BROOME  
 DRAWING TYPE 7200 DRAWING NUMBER AMEND.  
 FILE NUMBER 05/9941 **0560-096-1**

THIS DRAWING IS AN AMENDMENT OF THE APPROVED DRAWING.....

SCALE 1:2000  
 MICROFILM DATE 12 APRIL 2006  
 A 1

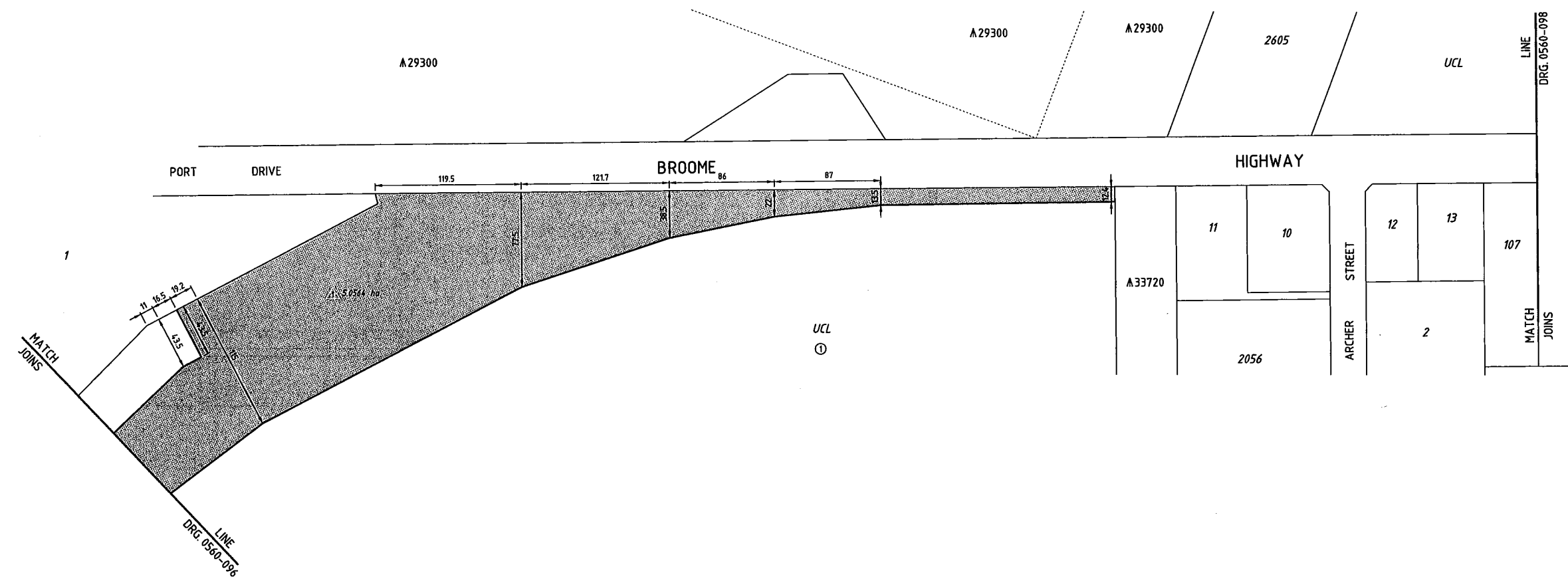
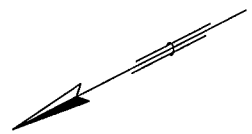
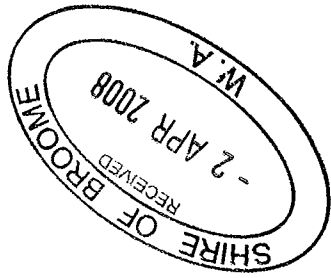

| ITEM | DESCRIPTION | C/T | OWNERSHIP | TOTAL AREA REQUIRED | REMARKS                              |
|------|-------------|-----|-----------|---------------------|--------------------------------------|
| 1    | UCL         |     | UCL       | 11.0515 ha          | AREA REQUIRED THIS SHEET = 5.0564 ha |

| AMENDMENTS | DESCRIPTION                | DATE | AUTHORISED | MEMO DATE |
|------------|----------------------------|------|------------|-----------|
| No. 1      | ITEM 1 REQUIREMENT AMENDED |      |            |           |

**LEGEND**

LAND REQUIRED FOR ROAD PURPOSES.

BOUNDARY TO BE SURVEYED.

- NOTES**
- DIMENSIONS AND AREAS ARE APPROXIMATE ONLY AND ARE SUBJECT TO SURVEY.
  - S.L.K. IS A M.R.W.A. STRAIGHT LINE KILOMETRE AND IS APPROXIMATE ONLY.
  - CADASTRAL MODEL : CAD0871A
  - HORIZONTAL DATUM IS MGA 94.

**KIMBERLEY REGION**

Telephone 1081 9158 4333 Fax 1081 9158 4334

**APPROVED FOR IMPLEMENTATION**

| FILE NUMBER | DATE | APPROVAL NUMBER |
|-------------|------|-----------------|
| 05/9941     |      |                 |

|            |            |        |
|------------|------------|--------|
| AUTHORISED | M. SALT    | 6/4/06 |
| APPROVED   | P. PODLAHA | 6/4/06 |

Government of Western Australia  
**MAIN ROADS** Western Australia

FINANCE AND SERVICES  
**PROPERTY MANAGEMENT**  
 Telephone 9323 4580 Fax 9323 4600

**Jimsan CAD Services**

TEL: 9 345 1802 EMAIL: langdon1@dodo.com.au

GRAPHIC PRESENTATION (ONLY) AUDITED IN ACCORDANCE WITH STANDARD 67-08-49 IN THE ROAD AND TRAFFIC ENGINEERING MANUAL.

**BROOME HIGHWAY, H42**  
**LAND DEALINGS**  
**SHEET 4 OF 6**

LOCAL AUTHORITY (001) SHIRE OF BROOME

|                        |                                     |
|------------------------|-------------------------------------|
| DRAWING TYPE<br>7200   | DRAWING NUMBER<br><b>0560-097-1</b> |
| FILE NUMBER<br>05/9941 |                                     |

**CERTIFICATE**

I HEREBY CERTIFY THAT THE INFORMATION SHOWN ON THIS PLAN IS CORRECT AT THE TIME OF DRAFTING HAS BEEN VERIFIED BY A DOLA SEARCH OF THE RELEVANT C/T'S AND SURVEY DOCUMENTS AND THE CADASTRE IS SPATIALLY CORRECT AS PER THE MRAA STANDARD 67-08-48.

PROJECT MANAGER J. LANGDON DATE 3/3/06

THIS DRAWING IS AN AMENDMENT OF THE APPROVED DRAWING.....

SCALE 1:2000 0 20 40 60 80 100 120 140 160 180 200 220 240 260 280 300 320 340 360 380 400

MICROFILM DATE 12 APRIL 2006

**A**  
**1**