

**KEY**

- Light Pole
- Outdoor Shower
- Stable Salt Pile
- Reticalation pit
- Summer Drainage Gate
- Soy Wire Anchor Post
- Line of Paving
- Gate
- Pool Drainage Channel
- Handrail

AMENDMENTS	
No.	DATE
REVISION	
BY	APP'D

Level Datum	AMD
Contour Interval	Minor - 0.1m Major - 0.5m

Note: This drawing has been prepared using the 2010 edition of the Australian Standard AS/NZS 1546:2010. It is the responsibility of the client to ensure that the drawing is up to date with the current standards. The client is responsible for any errors or omissions in this drawing. The client is responsible for any errors or omissions in this drawing. The client is responsible for any errors or omissions in this drawing.

<b>SHIRE OF BROOME</b> FIELD ST. (P.O. BOX 85) BROOME W.A. 6725 TEL (08) 9191 3466 FAX (08) 9191 3465	Survey RDW Design N/A Drawn Checked Contour Interval 0.5M Date 25-10-10	Scale AutocAD Ref: CIVILCAD Ref: MCD20/DA/VA/10-010 Approved
---	---	--

**BRAC**  
**Swimming Pool Area**

Sheet No. **1 of 1**  
Drawing Number **P10-010**



Trustee For Greensafe Trust  
ACN 010 973 609

BSA Lic No. 075266

ABN 38 382 331 854

31<sup>st</sup> January 2011

Mr. Steve Graham,  
Shire of Broome  
P.O. Box 44  
BROOME WA 6725

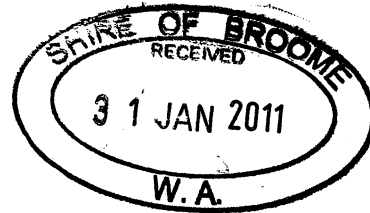

Dear Steve,

This is a quotation to extend the shade structure to cover the kids' pool as well as the 25M pool; this would be approximately 50M long X 30M wide and would collect back over the grassed area. I have included with this quote a drawing showing the covered area that this would produce. Because of the new orientation and the direction of the afternoon sun, there would be far more effective shade over the pool and indeed extending to the spectator area.

The floodlight on the eastern side of the pool would need to be relocated; but the floodlights adjacent to the synthetic grass or the kids' pool would not be impacted in any way.

The time frame for completion would not be affected if we had the go ahead by the end of February.

Cost for the above installed.....\$174,000.00. plus GST.

I hope that this gives you all the information that you need but if there is anything else you wish to know, please don't hesitate to give me a call on my personal mobile. 0418 727 475.

Kind regards

Barry Taylor. Director.

FILE:	10/08	
ACTION OFFICER:	SSPO	
ACTION: (sign & date)	NOTED SG-2/2/11	RESPONDED
RECORD NO:	110202 - 58328	
FURTHER REFERRAL ACTION OFFICER	Already received by E-mail / Fax	
ACTION REQUIRED	NOTE	SPON!

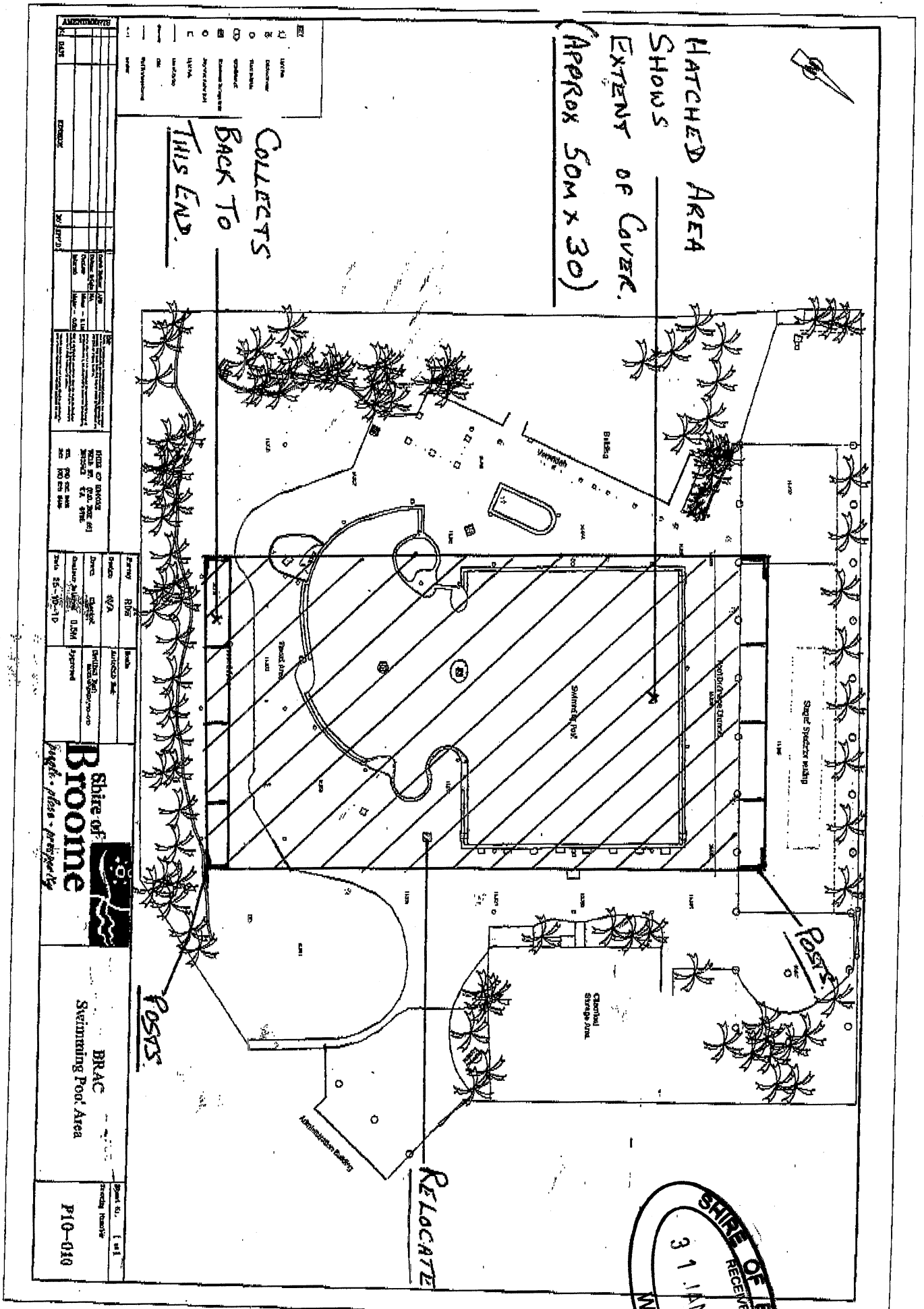

**Legend**

Symbol	Notes
Symbol	Structure
Symbol	Planting
Symbol	Swimming Pool
Symbol	Shed
Symbol	Water
Symbol	Other

**Site of BRAC Swimming Pool Area**

Date	28/01/2011
Time	08:59
Scale	1:100
Author	91913455
Check	
Drawn	
Approved	

**Site of BRAC Swimming Pool Area**

Area	1000m <sup>2</sup>
Perimeter	100m
Volume	1000m <sup>3</sup>
Weight	1000t

**Site of BRAC Swimming Pool Area**

Item	Quantity	Notes
Concrete	1000m <sup>3</sup>	
Rebar	100t	
Formwork	1000m <sup>2</sup>	
Water	1000m <sup>3</sup>	

**Shire of Broome**

BRAC Swimming Pool Area

1000m<sup>2</sup>

