

CROSS OVER PLAN
1:100

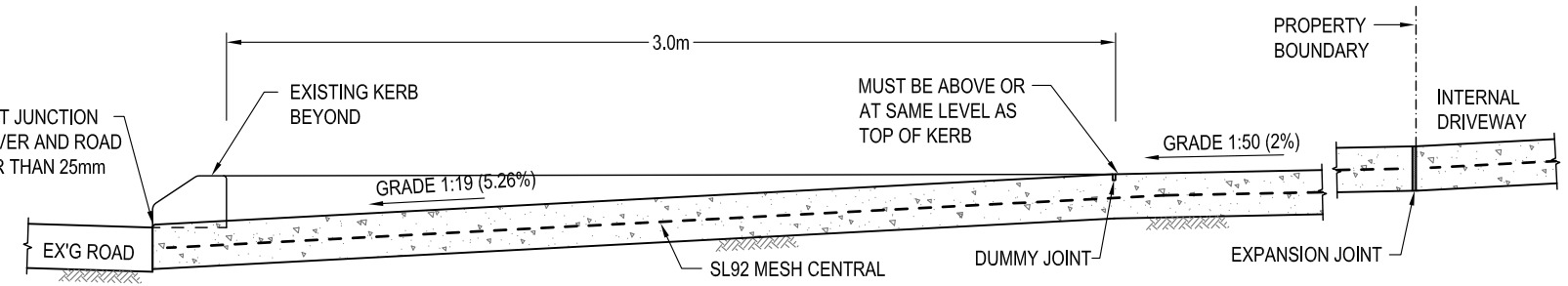

SECTION A
1:25

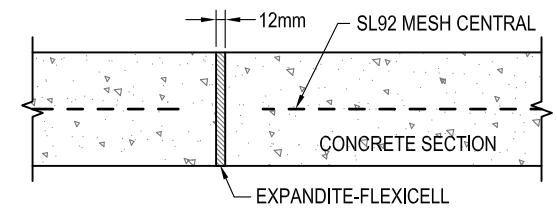

EXPANSION JOINT (E.J.) DETAIL
1:10

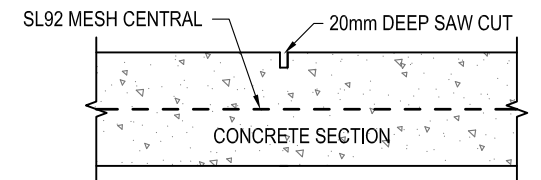

DUMMIED JOINT (D.J.) DETAIL
1:10

CROSSOVER TYPE	DIMENSIONS	REINFORCEMENT
TWO WAY	WIDTH: 6.0m (min) to 10.0m (max) WINGS: 3.0m x 3.0m AT BACK OF KERB LINE DEPTH: 150mm CONCRETE	TYPE: SL92 MESH CENTRAL
2 x ONE WAY CLEARLY INDICATING ENTRANCE ONLY & EXIT ONLY	WIDTH: 4.0m WINGS: 3.0m x 3.0m AT BACK OF KERB LINE DEPTH: 150mm CONCRETE	TYPE: SL92 MESH CENTRAL
ACCOMODATE SEMI TRAILER OR ABOVE	TO BE DESIGNED INDIVIDUALLY BY THE DEVELOPER AND SUBMITTED TO THE SHIRE FOR APPROVAL PRIOR TO CONSTRUCTION	

- NOTES:**
- CROSSOVER IS TO BE CONSTRUCTED AT RIGHT ANGLES TO ROAD AND PROPERTY LINES.
 - CONCRETE STRENGTH (f_c) TO BE 25 MPa AT 28 DAYS MINIMUM.
 - SURFACE FINISH TO BE WOOD FLOAT AND NON-SLIP WITH TOOLED JOINTS.
 - CONCRETE TO INCLUDE SL92 REINFORCEMENT MESH.
 - EXPANSION JOINTS: AT 5m-6m CENTRES, APPROVED MATERIAL SHALL BE EXPANDITE-FLEXICELL.
 - DUMMIED JOINT SPACINGS: 3m x 3m PANELS THROUGH CROSSOVER AND 4 PANELS (MIN) IN RAMP/WING AREA, AS SHOWN IN DIAGRAM.

A COUNCIL REPRESENTATIVE MUST INSPECT AND APPROVE THE CROSSOVER CONSTRUCTION BEFORE ANY CONCRETE IS POURED.

PHONE 9191 3456 FOR INSPECTION
THE REVISED DETAILS ON THIS DRAWING SHALL BE EFFECTIVE FROM 01/11/2013

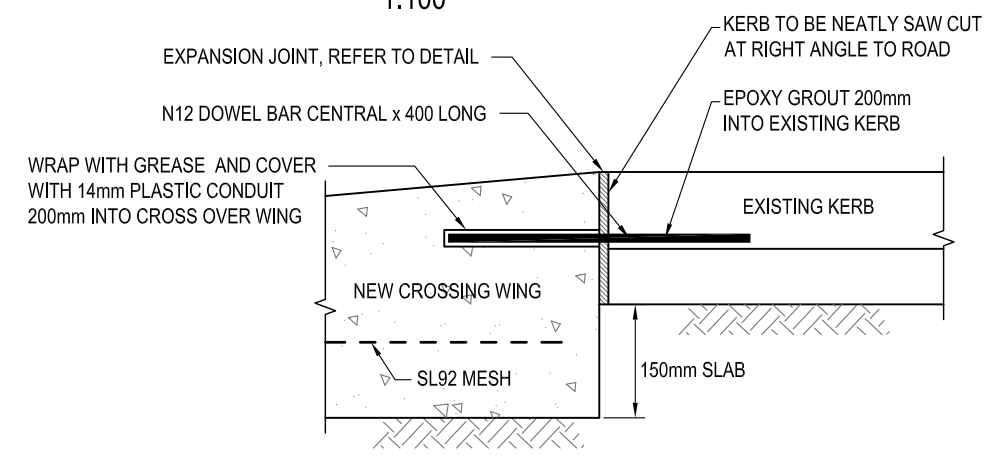

DETAIL B - KERB/ CROSS OVER CONNECTION
1:10

Amendments			
REV	Date	Details	By
1	01/03/2002	ADDITIONS OF GRADES	SW
2	26/06/2003	WING SPAN MODIFIED	SW
3	08/09/2004	ADDITION OF REO	MW
4	08/07/2013	REINFORCEMENT TYPE CHANGED	SW
5	26/09/2013	PLAN AND DETAILS REVISED	AR

SHIRE OF BROOME
WELD ST. (P.O. BOX 44)
BROOME W.A. 6725
TEL (08) 9191 3456
FAX (08) 9191 3455

Survey	N/A	Scale	1:100, 1:25 & 1:10 (A3)
Design	KW	AutoCAD Ref:	-
Drawn	KW	CivilCAD Ref:	-
Contour Interval		Approved	
Date	10/05/2001		



VEHICLE CROSSING

SPECIFICATIONS FOR COMMERCIAL CONCRETE CROSSOVERS

Sheet No.	1 of 1
Drawing Number	S00-003 REV. 5