

FOOTPATH TO CROSSOVER PLAN
SCALE 1 : 100

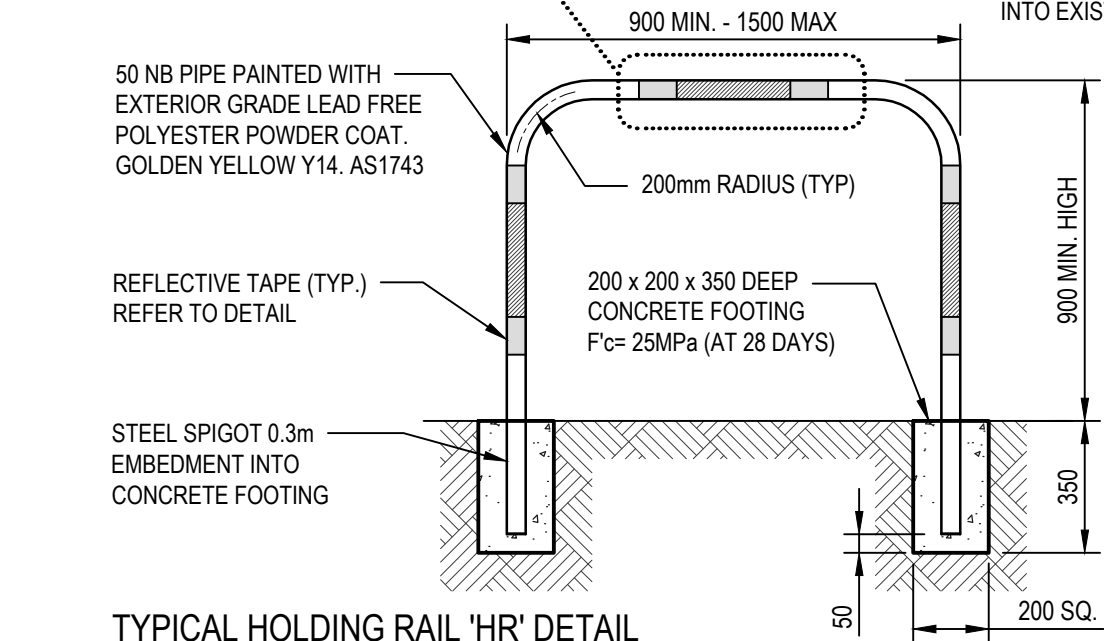

TYPICAL HOLDING RAIL 'HR' DETAIL
SCALE 1 : 20

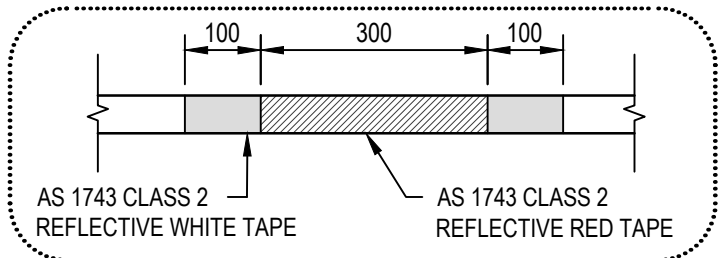
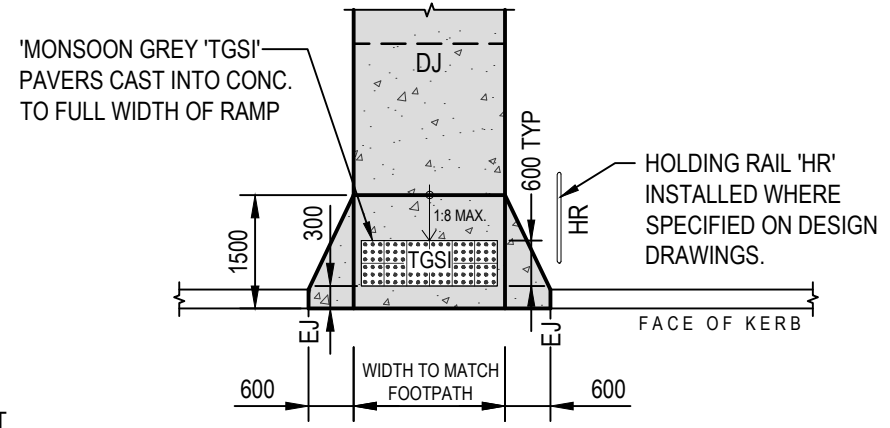

TYPICAL PRAM RAMP JUNCTION DETAILS AT EXISTING KERB
SCALE 1 : 100

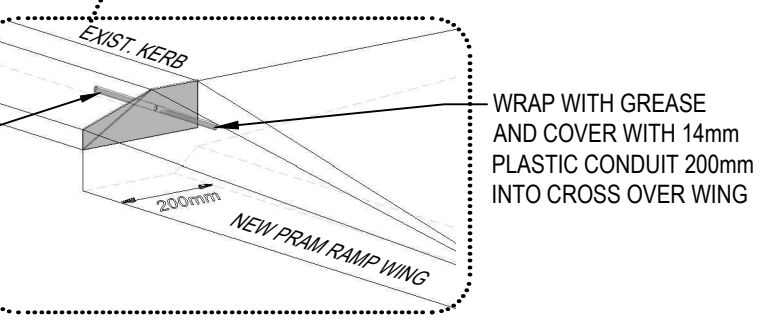

TYPICAL KERB / PRAM RAMP CONNECTION DETAIL
SCALE : N.T.S.

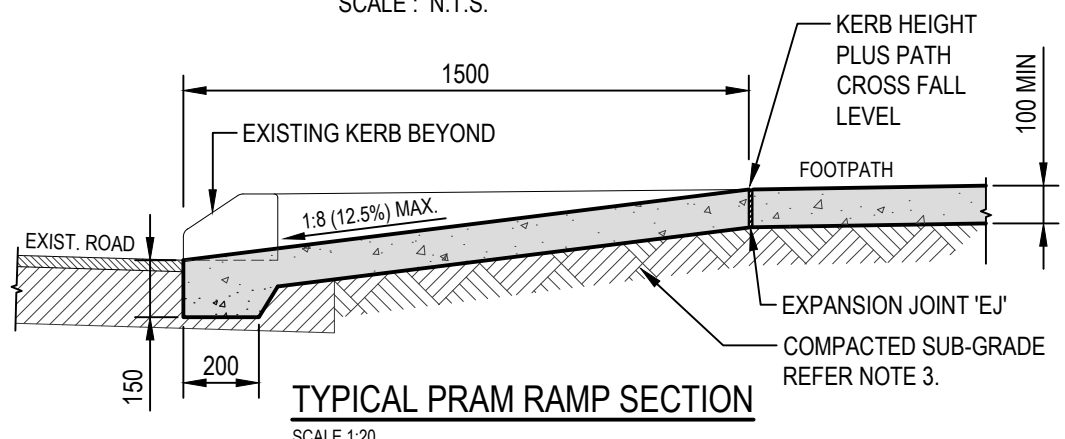

TYPICAL PRAM RAMP SECTION
SCALE 1:20

LEGEND	
DJ	DUMMY / CONTRACTION JOINT - REFER DETAIL
EJ	EXPANSION JOINT - SEE DETAIL THIS SHEET
HR	HOLDING RAIL - SEE DETAIL THIS SHEET
TGSI	TACTILE GROUND SURFACE INDICATOR AS NOTED

- NOTES:**
1. FOOTPATH WIDTH VARIES, REFER TO DESIGN DRAWINGS
 2. FOOTPATHS AND PRAM RAMPS TO BE MINIMUM 100mm THICK .
 3. SUB-GRADE TO BE COMPACTED TO 95% MMDD
 4. CONTRACTOR TO ARRANGE INSPECTION OF SUBGRADE BY THE SHIRE PRIOR TO POURING CONCRETE
 5. CONCRETE SHALL BE 25MPa COMPRESSIVE STRENGTH AT 28 DAYS FROM AN APPROVED PRE-MIX BATCH PLANT MAXIMUM AGGREGATE SIZE 20mm AND MAXIMUM SLUMP OF 80mm. THE CONTRACTOR SHALL ENSURE CURING OF CONCRETE TO ACHIEVE STATED COMPRESSIVE STRENGTH
 6. CROSS FALL OF FOOTPATH SHALL BE 1:50 (2%) UNLESS NOTED OTHERWISE
 7. EXPANSION JOINTS SHALL BE PLACED AT 6m CENTRES
 8. DUMMY JOINT/ CONTRACTION JOINT SHALL BE AT MAX. 2m CENTRES
 9. SURFACE TO BE BROOM FINISH, NON-SLIP, PARALLEL TO LINE OF KERB WITH TOOLED EDGES.
 10. RAMP TO FINISH FLUSH WITH BITUMEN WITH NO LIP
 11. ALL JOINTS TO BITUMEN TO BE SEALED WITH A BITUMINOUS SEALANT
 12. ALL NEW FOOTPATH TO BE 2.0m WIDE UNLESS OTHERWISE APPROVED BY THE SHIRE OF BROOME

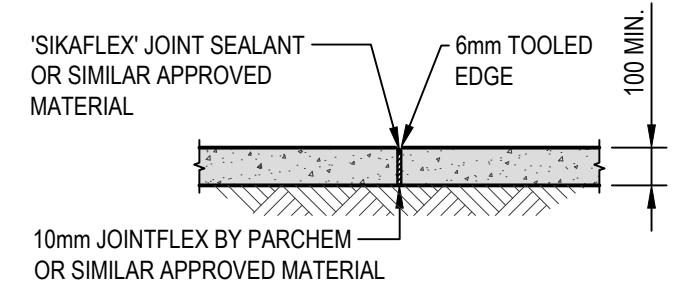

EXPANSION JOINT 'EJ' DETAIL
SCALE 1:20

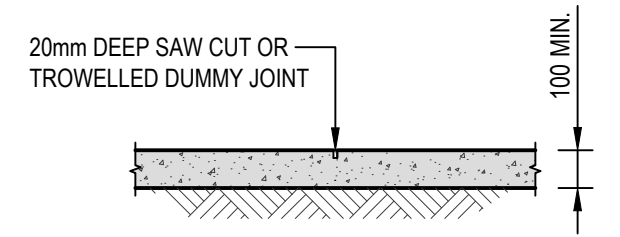

CONTRACTION / DUMMY JOINT 'DJ' DETAIL
SCALE 1:20

CHECK PRINT		
ACTION	INITIALS	DATE
DRAFTER	KDudley	07 Nov, 2019
CHECKED		
CORRECTED		

HORIZONTAL DATUM
VERTICAL DATUM
CONTOUR INTERVAL

SHIRE OF BROOME
27 WELD STREET (PO BOX 44)
BROOME WA 6725

TEL (08) 9191 3456
FAX (08) 9191 3455

Shire@broome.wa.gov.au



STANDARD DRAWING
FOOTPATH, PRAM RAMP
AND HOLDING RAIL DETAIL

DRAWING NUMBER STD-R-001

PROJECT NUMBER	STD-R
SHEET SIZE	A3
SCALE	AS SHOWN
REV	1

REV	DATE	DESCRIPTION	DRN	DES	CKD	PM
1	OCT 2019	SOB STANDARD DRAWING UPDATED - RE-ISSUED FOR CONSTRUCTION	KD	PC	-	-
0	27/04/2018	INITIAL ISSUE	JRH	LH		